

17 Perrots Terrace, Haverfordwest



PCM £500 PCM



This rental property is only available to those who meet the following criteria:

- a) Have been born in Haverfordwest and have lived in the town in excess of ten years and have attended a Haverfordwest school or
- b) Have been resident in Haverfordwest – or at least have worked in Haverfordwest in excess of twenty years.

If you meet the above criteria and would like to apply, please contact our Haverfordwest office on 01437 762538 for an application form. Applications will close on Thursday 30th June 2022.

Unfortunately, applicants already living in council owned properties will not be considered for the tenancy, except in extenuating circumstances.



**RK & son**  
**Lucas**  
PEMBROKESHIRE'S PROPERTY  
PROFESSIONALS

Serving the whole of Pembrokeshire from our offices in  
Haverfordwest and Milford Haven.

[www.rklucas.co.uk](http://www.rklucas.co.uk)

01437 762538 01646 695713



**RICS**







**Hall**

**Living Room**

4.00m x 3.20m (13'1" x 10'5")

**Dining Room**

4.00m x 2.00m (13'1" x 6'6")

**Kitchen**

3.60m x 3.0m (11'9" x 9'10")

**Bathroom**

2.30m x 2.10m (7'6" x 6'10")

**Utility**

**Landing**

**Bedroom 1**

4.20m x 4.20m (13'9" x 13'9")

**Bedroom 2**

4.20m x 2.30m (13'9" x 7'6")

**Outside**

Large enclosed rear garden predominantly of lawn with decking area

**General Notes**

**Please Note**

The successful applicants will be required to supply the Clerks to the Trust – R K Lucas and Son – with certificates, eg Birth and Marriage and other information justifying any claim made on their

application form.

The granting of this tenancy is totally at the discretion of the Trustees.



# Ground Floor



# First Floor

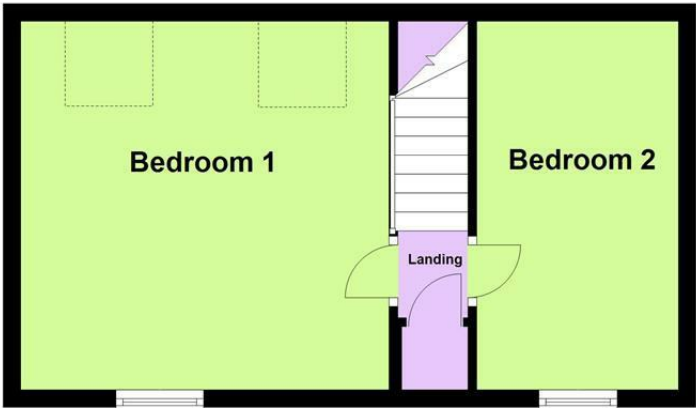

Total area: approx. 86.2 sq. metres (927.5 sq. feet)

For illustration purposes, do not scale.  
Plan produced using PlanUp.

Energy Efficiency Rating		
	Current	Potential
Very energy efficient - lower running costs		
(92 plus) <b>A</b>		<b>88</b>
(81-91) <b>B</b>		
(69-80) <b>C</b>	<b>68</b>	
(55-68) <b>D</b>		
(39-54) <b>E</b>		
(21-38) <b>F</b>		
(1-20) <b>G</b>		
Not energy efficient - higher running costs		
<b>England &amp; Wales</b>	EU Directive 2002/91/EC 	



These particulars are supplied subject to the property being unsold/let/unlet and on the express conditions that negotiations for purchase or otherwise are made through and deposit paid to R K Lucas & Son. The description is believed to be accurate, but it is issued as a guide only, thereafter the agents do not hold themselves responsible for any errors in description as the property will be sold/let according to the contract issued by the Vendor's/Lessor's Solicitors.